

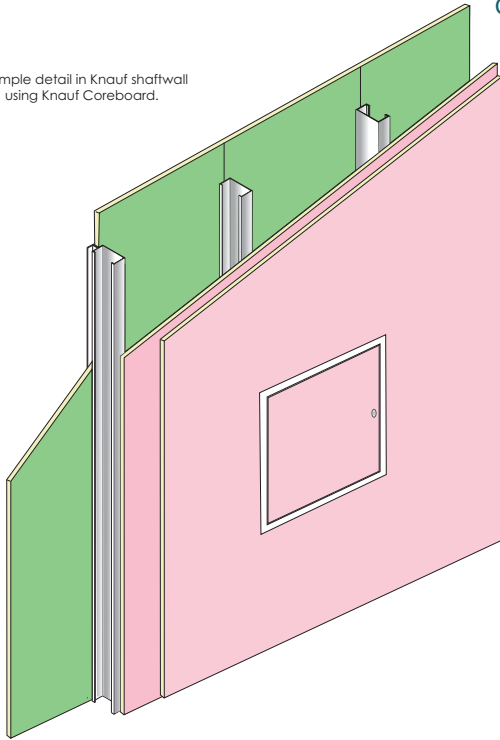

SHAFTWALL APPLICATIONS

Ceildoor Products Ltd Planetary House Planetary Road Willenhall Wolverhampton WV13 3SW

Example detail in Knauf shaftwall using Knauf Coreboard.



Composition of Hatches.

Frame:

1.2mm zintec, Welded construction to create a rigid composition then powder-coated white to all surfaces. (other colours available to order).

Door :

0.9mm zintec folded to all sides to create a rigid door shell then powder coated white to all surfaces. (other colours available to order).

Lock/s:

All units are fitted with budget locks as standard, however other locks such as tamper proof locks, key retaining locks and touch latches can be fitted to order.

Fitting

The frame should be screw fixed into position in the opening using the fixing holes located on all four side of the framework. It is recommended that sufficient independent bracing and support is obtained to ensure the safe opening and closing of the access hatch within its environment.

Structural information

The drawings on the right provide the information with regards to structural opening information however it is recommended that to create a sufficient opening to insert the access hatch frame this is normally 10mm up on the door size. Alternatively when ordering an access hatch to suit an opening take away 10mm from your opening dimension to achieve a door size.

Safety

It is extremely important that immediately after use of the access hatch that you close and lock it. Failure to do so will effect and impair the performance of the environment where it has been installed in the event of fire.

Fire Performance

This product has been designed to comply with fire resistance in accordance to BS 476 Part 22. The fire reports to substantiate this are available upon request. The sectional details above are guidelines on how the product should be installed into the fire rated application. It will match the assessed or tested construction. All of the structural components in this product and recommended methods of fixing are non- combustible .

Criteria

It is assumed that the access hatch will be installed within a supporting wall construction that has been previously tested and has shown it to be capable of satisfying the integrity performance criteria of BS 476: Part 22:1987, clause for a period of 120 minutes. Alternatively, the access hatch may be installed within a plasterboard ceiling that has been previously tested and shown to be capable of satisfying the integrity performance criteria of the relevant British Standard, for the minimum period of 120 minutes.

Extra protection against Moisture

Ceildoor metal access hatches are powder-coated white RAL 9010 full polyester paint. Even though the majority of access hatches are used internally, we use full polyester powder coating which is recommended for general exterior situations, where good weathering resistance is required against high levels of atmospheric moisture or in particularly aggressive atmospheres. Stainless steel constructions are available to order.

Plaster Faced Door

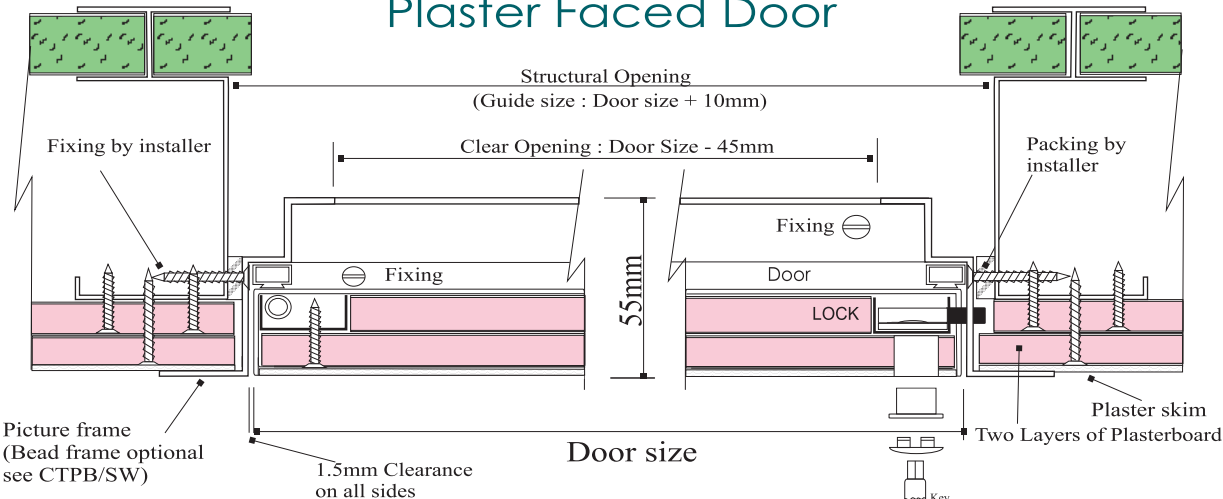

Safety

It is extremely important that immediately after use of the access hatch that you close and lock it. Failure to do so will effect and impair the performance of the environment where it has been installed in the event of fire.

All recommendations, suggestions on the use of our products are made in good faith and without guarantee since the conditions of use are beyond the control of Ceildoor. It is therefore the customers responsibility to ensure that each product is fit for its intended purpose and that the actual conditions of use are suitable. Ceildoor pursues a policy of continuous product development and reserves the right to amend specifications without notice.